



**NATURAL LIGHT  
FABRIC STRUCTURES**



[www.nlfabric.com](http://www.nlfabric.com)



What are Natural Light Fabric Structures?

Natural Light Fabric Structures are cost-efficient building solutions consisting of a steel frame and fabric membrane cover. We offer the SP Series, DP Series and Hybrid buildings. Natural Light Fabric Structures maximize your investment by saving energy and increasing productivity.

Natural Light Fabric Buildings are versatile solutions for many industries and applications. Here are just a few examples:

- Agriculture: Beef Barns, Dairy Barns, Hay Storage, Equipment Storage
Sports and Recreation
Commercial/Industrial
Environmental, Recycling, Waste Water
Marine and Aviation
Temporary Construction Storage and Shelter
Oil and Mining
Commodity Storage: Grain, Fertilizer
Salt/Sand Storage



Advantages

A building from Natural Light Fabric Structures provides many advantages, including:

- Clear span (no interior columns) - SP and DP Series offer widths from 18'-120' with no interior columns to maximize usable space.
Modular frame (Hybrid buildings) - Offers clear span up to 260' but also allows you to add interior columns, increase building width and adjust sidewall eave heights.
Engineering (DP and Hybrid Series) - Engineered to meet all your local wind, snow and unbalanced snow load requirements.
Go green - Fabric designs allow natural light through the roof and side walls reducing the need for skylights or artificial lighting during daylight hours.
Low maintenance - Due to galvanized finish and durable high-density polyethylene fabric.
Ease of installation - Buildings are designed to be installed faster than other fabric, metal or wood-framed buildings.
Reduced condensation - Improved air circulation and less heat build-up compared to metal pole barns and Quonset huts.
Pre-galvanized steel - Utilized on all non-welded components.
Hot-dipped galvanized steel - All welded components receive a hot-dipped galvanized finish. Hot dipping after fabrication ensures high quality corrosion protection inside and out.
Customization - Structures can be customized to incorporate colors, ventilation, interior layouts, door and end wall options, foundations and space requirements.
Local dealer network - NLFS local dealers will support you from the original concept and cost estimate through installation of your new building.
Made in the USA

# Engineering

The DP series and Hybrid building are pre-engineered to serve applications where structural integrity is the most important factor. All of our DP Series and Hybrid buildings are engineered to meet all wind, snow and unbalanced snow load requirements.

Because we use more steel in each building, a better method of securing the fabric roof and a more durable production process than our competitors, you are assured of getting the highest quality building.

## **DP Series** *40'-120' Widths* *Post and Ground Mount Applications*

### **Steel Frame Finishes:**

- Primary structural frames hot-dipped galvanized.
- Secondary structure framing is pre-galvanized to provide rust and corrosion resistant product protection.

### **Fabric Cover:**

- 12 oz. Nova-Shield Fabric with ArmorKote, manufactured by ECP Fabric.
- Other fabrics available upon request.



## SP Series 18'-32' Widths - Post and Wall Mount Applications



Look no further than the SP Series when an engineered building is not required, yet a high quality, dependable and cost-effective fabric cover solution is needed.

### Steel Frame Finishes:

- Pre-galvanized steel is used to provide rust and corrosion resistant product protection.

### Frame Options:

- 18' to 22' - 2-3/8" diameter pipe.
- 24' to 32' - 2-7/8" diameter pipe.
- Metal end wall framing options available.

### Fabric Cover:

- 12 oz. Nova-Shield Fabric with ArmorKote, manufactured by ECP Fabric.

## Hybrid Buildings

Hybrid Buildings from Natural Light Fabric Structures offer the strength of Behlen welded-plate rigid frames and the advantages of a polyethylene roof from Natural Light Fabric Structures. The result is a stronger, brighter, and more cost-effective grain, fertilizer or commodity storage solution.

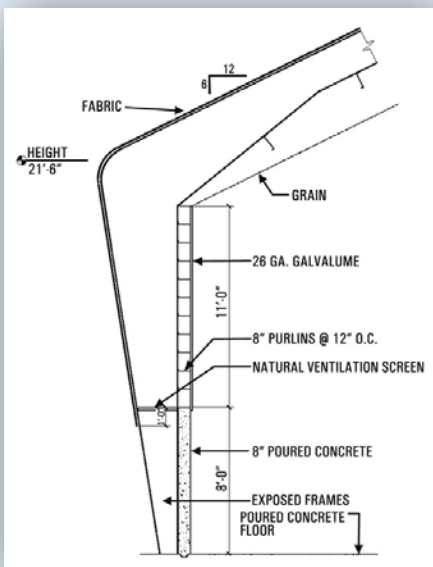

## Hybrid Advantages

- Clear span or interior columns available allowing greatest flexibility.
- Ability to span any width or length needed to fit your existing site.
- Engineered to carry fill conveyor and catwalk loads.
- Engineered to carry temperature monitoring cables.
- Engineered to carry 19' containment at sidewalls.
- Easily designed for future expansion.
- Reverse tapered or standard frame options.
- Manual unload or reclaim tunnel and conveyor system available.
- Flush floor or above ground aeration systems available.
- Designed and engineered to meet all wind, snow and unbalanced snow load requirements.
- **Behlen Manufacturing has provided innovative building and engineering for 75 years. This is proven engineering you can count on.**

